



Boardman Local School District High School Stadium Boardman, Ohio

The proposed Boardman High School Stadium project is planned to seat 4,000 home patrons and 3,000 visitors and includes a new synthetic turf system, band seating with canopy structure, electronic scoreboard with messaging, and gateway structure with dual ticket booths. Additional structures will house locker rooms, restrooms and concessions. An athletic training facility, field lighting & all-weather 8-lane track are existing. The project is currently in its fundraising phase, and is estimated at approximately \$3.6 million.



energy
explore
educate
envision
efficiency
experience
expectation
environment

Team 8e
architecture

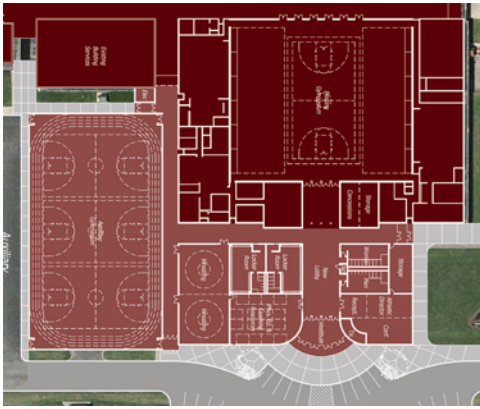

Boardman Local School District High School Athletic Center Boardman, Ohio

The proposed Boardman High School Athletic Center project is planned as an addition to the existing high school and consists of a new 3-court auxiliary gymnasium with 4-lane training track and indoor pole-vault. Other features include 2 wrestling areas, men's & women's locker rooms, public restrooms, a coaching office & resource center, and the athletic director's office with ticket area and sales windows with both interior and exterior access. New concessions and a Hall of Fame are also included.



The project is currently in its fundraising phase, and is estimated at approximately \$3.2 million.



energy
explore
educate
envision
efficiency
experience
expectation
environment

Team 8e
architecture



Boardman Local School District High School Multi-purpose Center Boardman, Ohio

The Boardman High School Multi-purpose Center provides training facilities primarily for wrestling, but can also be used for Spring baseball & track training. The flooring is a raised, vented system of hardwood sheathing to provide the safety and playability of a traditional wood system at less cost. Other features include lockers, restrooms & showers, and equipment storage for indoor & outdoor sports. Cost \$450,000.

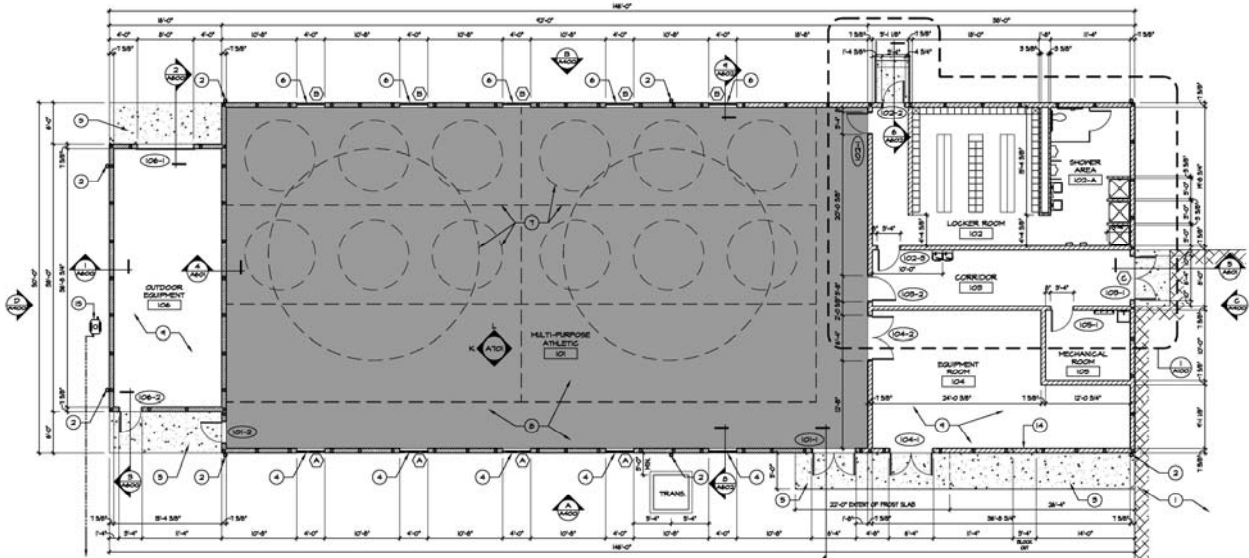

energy
explore
educate
envision
efficiency
experience
expectation
environment

Team 8e
architecture



Boardman Local School District High School Tennis Courts Boardman, Ohio

The Boardman High School Tennis Court project consisted of eight existing tennis courts experiencing severe lateral cracking and were no longer repairable. Through intensive evaluation, it was determined that the aggregate base material was highly expansive and an unusual water source was introducing moisture under one side of the courts. The courts were demolished and reconstructed with the proper slope, aggregate base & drainage, new asphalt surface, top coating and net system at a cost of \$250,000.

Before Demolition & Reconstruction



New Base Material & Asphalt Paving



New Surface Coating & Net System



energy
explore
educate
envision
efficiency
experience
expectation
environment

Team 8e
architecture